

SD-50 Super Duty Wall Covering

- .050-inch aluminum with super duty polyurea coating
- Wainscot or full height installation
- Trim and corner pieces available
- Full range of RAL colors available
- Other thicknesses available

Standard Sheet Sizes

- 48-inch x 96-inch
- 48-inch x 120-inch
- Custom sizes available

Mounting Options

- ADH-50 adhesive
- Mechanical fasteners (supplied by others)
- Pre-drilled mounting holes available

SD-50-CR-2 chair rail

- 1/4-inch aluminum with super duty polyurea coating
- 2-inch height
- Stock lengths
- Custom sizes available

.050-inch aluminum sheet with super duty polyurea coating

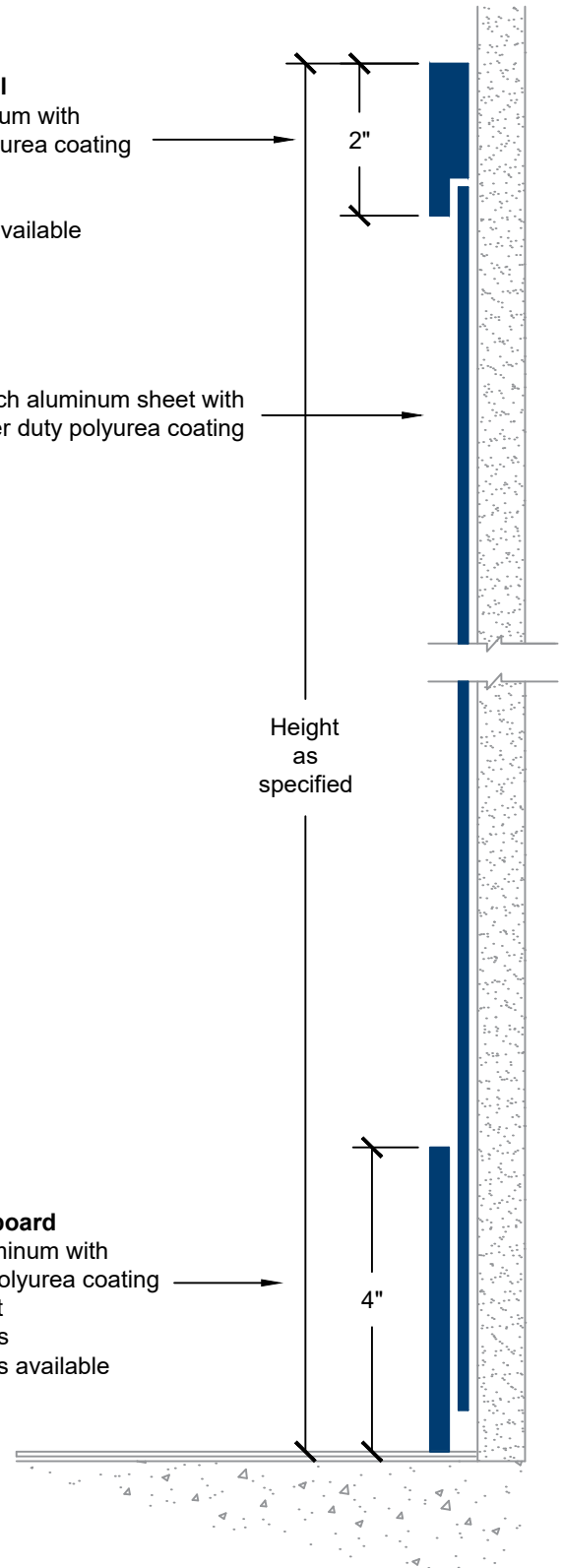

Wainscot wall panel

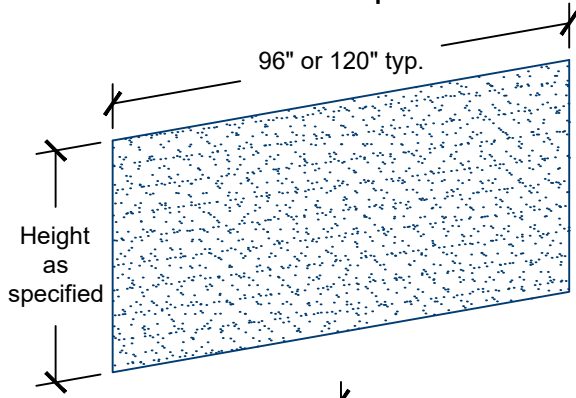

Full height wall panel

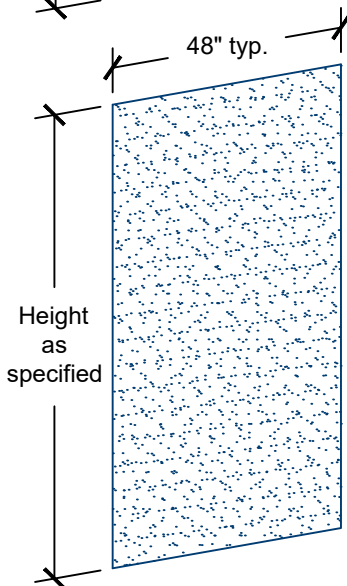

SD-50-BB-4 baseboard

- 1/8-inch aluminum with super duty polyurea coating
- 4-inch height
- Stock lengths
- Custom sizes available

SD-50 Super Duty Wall Covering

- .050-inch aluminum with super duty polyurea coating
- Wainscot or full height installation
- Trim and corner pieces available
- Full range of RAL colors available
- Other thicknesses available

Standard Sheet Sizes

- 48-inch x 96-inch
- 48-inch x 120-inch
- Custom sizes available

Mounting Options

- ADH-50 adhesive
- Mechanical fasteners (supplied by others)
- Pre-drilled mounting holes available

Inside corner detail

- Butt seam
- Seal with caulk if required (by others)

SD-50-OCG-252 outside corner

- 1/4-inch aluminum angle with super duty polyurea coating
- 2-inch wing size
- Height as specified

Joint detail

- Butt seam
- Seal with caulk if required (by others)

