

SD-402-EW Super Duty End Wall Condition

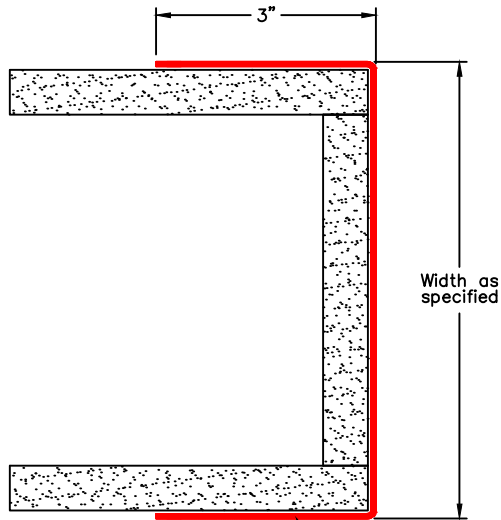

Super Duty End Wall
 • .050" formed aluminum
 • .030" polyurea coating

FEATURES:

- .050" aluminum sheet coated with Super Duty polyurea
- Custom lengths, angles, and wing sizes are available
- Stock lengths: 4'-0" & 8'-0"
- Custom color matching

MOUNTING OPTIONS:

- Adhesive:
 - ADH-50 adhesive supplied separately
- Drilled:
 - Clearance holes for #8 fastener ABSS-113 #8 x 1 1/2" (38) oval head sheet metal screw and ABCW-132 stainless cup washer supplied separately as required

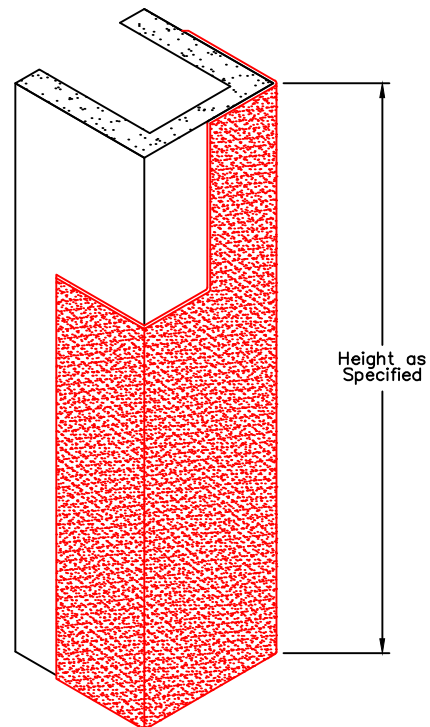
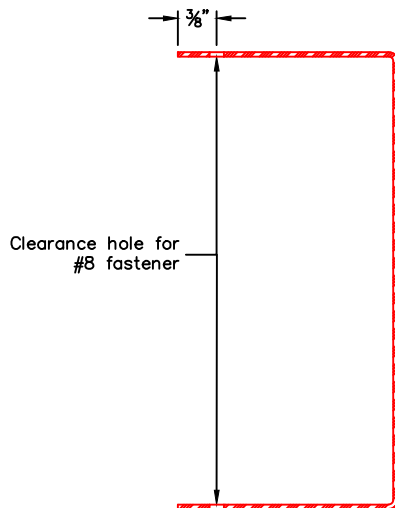

OPTIONAL DRILLING:

- Standard spacing: 3" from each end and spaced evenly not to exceed 36" oc

Customer:	Project:	CG-402-EW
Architect:	Sales Rep:	